

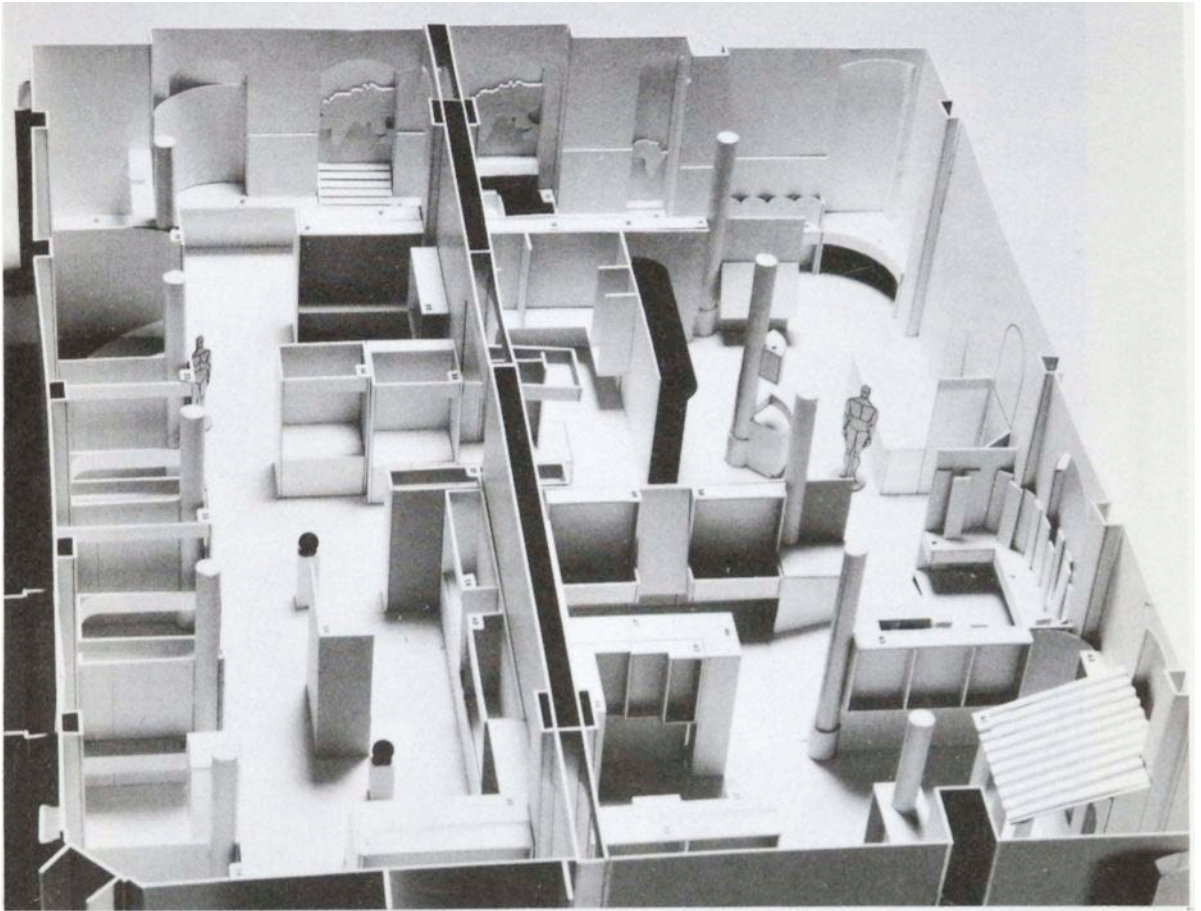

UNIVERSITY OF CAMBRIDGE

MUSEUM OF ARCHAEOLOGY AND ANTHROPOLOGY



*Model of proposed new archaeological displays
(Richard Daynes, F.S.I.A., Consultant Designer)*

ANNUAL REPORT FOR 1981-82

The Faculty Board of Archaeology and Anthropology presents to the University the 94th Annual Report of the Museum of Archaeology and Anthropology for the academical year 1981-82.



New museum store, completed 1981.

ADMINISTRATION

STAFF

At the beginning of the academical year under review Mr Peter Gathercole retired from the Curatorship and was replaced by the present incumbent. The Faculty Board wishes to record its indebtedness and gratitude to Mr Gathercole for his excellent work during the eleven years of his tenure of office. The Board also records its thanks to Professor Thurstan Shaw, whose resignation as Honorary Keeper of the West African archaeological collections was received during the year.

The Museum Committee met three times during the year, under the Chairmanship of Dr S. P. Hugh-Jones.

During 1981-82 the staff of the Museum was as follows

Curator: David W. Phillipson, M.A., Ph.D., F.S.A.

*Senior Assistant Curator (post-palaeolithic
archaeology):*

Miss M. D. Cra'ster, M.A., F.S.A.

Assistant Curator (palaeolithic archaeology):

P. L. Carter, M.A., Ph.D.

Assistant Curator (anthropology):

D. A. Swallow, M.A., Ph.D.

Attendant: B. Lewis

Attendants (part-time): Mrs 9D. Brett

T. Coleman

Honorary Keepers:

H. K. Cameron, M.A. , Ph.D., F.S.A. (*Brass rubbings*)

G. I. Jones, M.A., Ph.D. (*Nigerian anthropology*)

G. A. Lewis, M.A., B.M., B.Ch., M.R.C.P., Ph.D.

(*Melanesian anthropology*)

Miss J. Liversidge, M.Litt., F.S.A. (*Romano-British
collections*)

L.E.R. Picken, M.A., Ph.D., Sc.D., F.B.A. (*Organology*)

Professor C. T. Shaw, M.A., Ph.D., F.S.A., C.B.E. (*IVest
African archaeology*)

In addition, the following assistant staff of the Faculty of Archaeology and Anthropology held specific Museum responsibilities:-

Secretary (part-time):	Mrs. R.C. Fisk, M.A.
Museum Assistant:	J. Osbourn
Head of Workshop:	P.W. Smith
Workshop Assistant:	M. Payne
Photographer:	G.J. Owen, L.I.I.P.

A substantial number of helpers, including students, have worked in the Museum during the year, some of them as volunteers. These part-time and occasional helpers have contributed a very great deal to the year's achievements and the Board is extremely grateful to them. Their names are recorded in later sections of this report.

It has become increasingly apparent during the year that the small size of the Museum's staff is a serious impediment both to the efficient conduct of the Museum's reorganisation programme and to the maintenance of an acceptable level of service to the international academic community. Despite strenuous efforts by the curatorial staff and a number of helpers, the Museum has not always been able to assist visiting researchers to the extent that it would wish. Work on updating the Museum's catalogue will also not be completed in the foreseeable future without additional manpower. The Faculty Board intends shortly to make proposals to the University for alleviating this situation.

FINANCE

The Museum's allocation of University funds for recurrent expenditure was increased in compensation of the effects of inflation. This allocation remains at a low level and the Museum relies to a large extent on nonrecurrent grants for particular projects. Such grants were received during 1981-2 for the reorganisation of the

collections (£6,000) and for the purchase of books on museology to be placed in the Haddon Library (£480).

As recorded in later sections of this report, grants were also received during the year from the Crowther- Beynon Fund, the Evans Fund, the Area Museums Service for South Eastern England, the Cambridgeshire Museums Advisory Committee and the Purchase Grant Fund administered by the Victoria and Albert Museum.

EXHIBITIONS

A major temporary exhibition. Patterned Threads: Ikat fabrics from Sarawak and India, was organised by Dr Swallow on the Andrews Balcony. Arranged to coincide with the publication by Ruth Bean of a new edition of Iban or Sea Dyak Fabrics and their Patterns by A. C. Haddon and L. E. Start (first published by Cambridge University Press in 1936), the exhibition was opened on 29 April 1982 and continued until September. The exhibits consisted of ikat cloths from Sarawak acquired by the late Dr A. C. Haddon in 1899 and comparable material obtained, with extensive photographic and other documentation, by Dr Swallow during her recent research in the Orissa region of India. Temporary assistants who worked on the exhibition included Miss T. Campbell, Mr J. Hardy, Miss B. Jones, Mr C. McLaverty, Mrs C. Parden, Miss A. Srinivasan, Dr C. Steele and Mr H. Whittle: their help is greatly appreciated.

A series of glazed frames was mounted on the Museum staircase for the presentation of temporary photographic exhibitions. Two concurrent displays on the southern Sudan, The Zande Potter and Moru Grave Monuments were organised by the Curator. Ms G. L. Barnes of the Department of Archaeology presented a display entitled Tamazukuri: Japanese Protohistoric Beadmaking.

No significant changes were made to the permanent displays other than those necessitated by the long-term development programme. The Andrews Balcony was re-opened in April following a period of closure necessitated by the transfer of research collections into the adjacent Bevan store. In June the entire ground floor display area was closed and work begun on dismantling the exhibits preparatory for building work in connection with the new Clarke Hall archaeological gallery, described below.

RE-DEVELOPMENT

STORES

Further substantial progress has been made on checking and re-ordering the collections, packing them into standardised boxes and incorporating them in the new stores at Downing Street and elsewhere. Intensive work was undertaken on the African Stone Age collections and on ethnographic material from New Guinea, Oceania and East Asia. Mrs M. H. Harris continued her volunteer work on archaeological material from Honduras and Tobago. During the year the very extensive body of material stored in the ground floor exhibition gallery was removed and much of it processed in the manner described above. Much of this work was undertaken by the following temporary assistants:-

Mr R. Baldwin	Mr I. Glennie	Miss E. McLaughlin
Miss A. Bliss	Miss J. Grover	Mr C. McLaverty
Miss T. Campbell	Mr J. Hardy	Miss J. Nicholson
Mr B. Chukwuezi	Miss M. Hawes	Mrs C. Parden
Mr P. Cole	Mrs G. Heyworth	Miss A. Paterson
Miss J. Defrates	Miss C. Hobba	Mr M. Pearce
Miss C. Diamantis	Miss M. Holmes	Mr T. Reynolds
Mr J. Eboreime	Miss B. Jones	Dr C. Steele
Miss K. Fernie	Miss A. Lutyens-	Mr H. Whittle
	Humphrey	

CATALOGUE

The Museum catalogue was transferred to a spacious room (formerly the office of Professor C.B.M. McBurney) on the second floor of the main building, adjacent to the Bevan Workroom. Thus, for the first time in many years, all the Museum's facilities at Downing Street are housed within the main building.

With the progress that has been made on re-ordering the collections, and their resultant increased use for research, the inadequacies of the present catalogue have been

emphasised. It seems probable that only a computerised catalogue will meet our long-term needs. Dr A. Fletcher, Keeper of Documentation and Data Retrieval at Leicestershire Museums, has been retained as a consultant to undertake a study of the Museum's needs and to make recommendations for future development of the catalogue and associated documentation systems.

ARCHIVES

During the re-development of office accommodation on the first floor of the Museum, two Archive Rooms were created in 1979. With the aid of a grant of £970 from the Cambridgeshire Museums Advisory Committee, Mr M. Evans v/as employed for three months from August 1982 to undertake sorting and preliminary cataloguing of the archives, which contain much useful documentation relating to the collections and the history of the Museum.

CLARKE HALL

Plans are now being finalised for the total replacement of the archaeological displays on the ground floor of the Museum. This project is seen as the first stage of a complete overhaul of the Museum's displays, following the reorganisation of the stores and the research collections. It is hoped that the new Clarke Hall display will be completed in time for opening on the occasion of the Museum's centenary celebrations in April/May 1984 and that work on the first and second floor displays will take place in subsequent years.

Approval has been given by the General Board for building works, to be undertaken between October 1982 and February 1983, which will create a single exhibition gallery of some 270 square metres in the Clarke Hall. This work has been made possible by a generous grant of £21,747 from the "Housing the Museums Fund" of the Museums and Galleries Commission. The assistance of the University's Estate Management and Building

Service in planning this project has been much appreciated and is gratefully acknowledged.

Meanwhile, assisted by a grant from the Area Museums Service for South Eastern England, Mr Richard Daynes has been commissioned to prepare detailed cost designs for the new Clarke Hall displays and for the cases in which they will be housed. The displays will cover the fields of World Prehistory and Local Archaeology, the latter continuing into the post-medieval period. Considerable thought is being given, both by the curatorial staff and by the designer, to the problems associated with the presentation of such extensive and complex material within a single gallery. The comprehensive coverage of the Museum's archaeological collections provides an unparalleled opportunity for such a display.

Fund-raising is now being undertaken to meet the very considerable costs of the new displays. A substantial University contribution has already been approved by the General Board, and grants have also been made from the Crowther-Beynon Fund, the Evans Fund and the American Friends of Cambridge University. Further large donations will be necessary, however, if the project is to be completed as planned.

CONSERVATION

Mr Smith treated a total of 94 objects in the Museum's Conservation Laboratory, including specimens from the Museum collections and from excavations conducted by staff of the Department of Archaeology. Design and construction of a new tank has greatly facilitated treatment of wooden objects recovered from waterlogged archaeological deposits. Major projects included work on a Roman bronze patera, an Asian leather belt decorated with semi-precious stones, and on specimens excavated at sites in the Somerset Levels and at Meare East Lake Village.

Mr P. E. Danks brought a group of students from Lincoln College of Art to examine the Museum's conservation facilities. Subsequently a small number of specimens requiring routine conservation was loaned in order to receive treatment at the College. This arrangement has had the double benefit of providing useful experience for students at Lincoln and of relieving pressure on the Museum's own staff and facilities. The items loaned have already been returned, and the standard of work is highly satisfactory: it is hoped to repeat the arrangement in future years.

RESEARCH

Over one hundred and twenty researchers from outside Cambridge visited the Museum by appointment to examine items in the research collections. It is regretted that, due to the heavy pressure of re-organisation work, parts of the collections were on occasion inaccessible and several research visits had to be postponed. A very large number of research enquiries was also dealt with by correspondence. Requests to make use of the research collections continue to increase and additional staff will be necessary if this service is to be maintained.

The subjects investigated by visiting researchers may be summarised as follows:-

Anthropology

General	7
African	2
American	10
Asian	13
Australiasian/ Oceanian	4
Total	<hr/> 36

Archaeology

Palaeolithic And General	14
British	33
European	1
Near Eastern/ Indian	5
African	10
American	11
Total	<hr/> 74

Historical	3
Museum Archives	5
Museology	5

The origin of visiting researchers is shown below:-

	British Isles	Europe	Africa	Asia	Australasia/Oceania	America
Universities	35	3	-	-	3	18
Museums	11	4	2	2	2	1
Research units etc.	6	-	-	1	-	-
Schools	2	-	-	-	-	-
Other	28	-	1	-	1	3
Total	82	7	3	3	6	22

EDUCATIONAL

Several professional and educational bodies visited the Museum during the year. The Museum Ethnographers' Group held their 1982 Annual General Meeting here, toured the Museum and were addressed by the Curator and by Professor J. R. Goody. Groups of students from the Museum Studies Department of Leicester University and from Lincoln College of Art toured the Museum's facilities. Visits were also made by a field class of archaeology students from Liverpool University, by several W.E.A. and University extra-mural classes and by 40 groups from local schools. The Cambridge Antiquarian Society, the Cambridge Archaeology Field Group and the Young Archaeologists Club also held meetings in the Museum.

PUBLIC

During the year public attendances at the Museum totalled 10,689. The significant reduction over figures recorded in previous years may be largely explained by the closure of the archaeological gallery during the summer, when public attendances are normally high.

ACQUISITIONS

New acquisitions accessioned during the year totalled 3096 catalogue entries, the highest total ever recorded. In addition, 22 deposits were made and 1541 previously unaccessioned items were registered.

GIFTS

Following effective completion of work at the Museum by Dr T. Holland and Lady Wheeler on preparing for publication the results of Dame Kathleen Kenyon's excavations at Jericho, the British School of Archaeology in Jerusalem presented the entire type series of pottery from this important site to the Museum, together with its associated documentation. We are most grateful to the School both for this important gift and for a generous donation towards the cost of housing this extensive collection.

The following gifts are gratefully acknowledged:-

- Mr P. Bond - Querns from Haslingfield, Cambs (1981.117)
British School of Archaeology in Jerusalem - Artefacts from Jericho as noted above (1982.33-603, 615-750, 879-1351, 1354-2856, 2910)
- Mr R. M. Brown - Bronze razor from Soham, Cambs (1982.1353)
- Professor J.G.D. Clark - Flint implements from sites in England and Ireland, Indian Neolithic artefacts (1981.143-163)
- Mr M. Delanoy (Haddenham Farmland Museum) - sixteenth-century pottery from Babylon Kilns site, Ely (1982.2927-2931)
- Lady Duffus - Nigerian and Ghanaian rattles and clothing collected by Sir William Duffus (1982.2899-2903)
- Miss S. Garner - Roman nails from Inchtuthil, Perthshire (1982.3023)
- Girl Guides Association - Anglo-Saxon loomweights from Great Wilbraham, Cambs (1981.118)
- Dr G. I. Jones - Nigerian and South African clothing, sculpture and paintings (1982.2904-2909)
- Mr R.H. Poynder - Roman pottery and glass from the Levant (1982.2923-2926)

Mr B. Spalding (via Scunthorpe Museum) - New Guinea mask
(1982.1352)

Mrs M. G. Steen - Chinese clothing and other items collected
by Dr J. P. Maxwell (1982.2857-2898, 2911-2922)

Sir Eric S. Thompson bequest - American pottery and other
items, Himalayan paintings (1981.93-115).

In addition, the following items were presented to the
Museum in recognition of grants from the Crowther-Beynon Fund:-
Mrs L. Donley - Ethnographic collection from Lamu, Kenya (1982.
604-614)

Professor N. Hammond - Maya pottery items (1982.2932-2937)

Dr P. Henley - Panare ethnographic collections from Venezuela
(1982.807-877)

Dr T. Holland - Artefacts from Tell es Sweyhat, Syria (1981. 119-
142, 185)

Miss H. Moore - Marakwet ethnographic collection, Kenya (1982.
751-806)

Dr D. A. Swallow - Textiles from India and Thailand (1982.3-29,
31, 32)

Miss A. Welbourn - Marakwet ethnographic collection, Kenya (1
982.2938-3022) .

Discussions were held in Jersey with representatives of La
Societe Jersiaise and the Jersey Heritage Trust concerning the
ultimate disposition of the palaeolithic collections resulting
from excavations carried out at La Cotte de Saint Brelade between
1961 and 1978 by the late Professor C.B.M. McBurney with, in many
years, the aid of grants from the Crowther-Beynon Fund.

PURCHASES

The major item purchased for the collections during the year was a collection of Balinese shadow puppets acquired, through the good offices of Professor J. R. Goody, by means of grants from the University's Evans Fund and from the Museum Purchase Fund administered by the Victoria and Albert Museum. Field Research by Mr J. Darling has provided detailed documentation for these specimens, and was aided by means of a grant from the Crowther-Beynon Fund.

Grants from the Crowther-Beynon Fund and the Victoria and Albert Museum's Museum Purchase Fund financed the purchase of seven bronze Celt-Iberian human figurines of the mid-first millenium B.C. (1981.164). A lead wool- weight from Histon, Cambs., (1981.116) was also purchased.

Approval was given for the establishment of an ongoing Acquisition of Specimens Fund for the Museum, and a grant was made from the Crowther-Beynon Fund to provide an opening balance.

DEPOSITS

Marakwet artefacts from Kenya were deposited by Miss H. L. Moore (1982.D.1-6) and Miss D. A. Welbourn (1982.D.8-23) .

LOANS

The following loans were made or continued for temporary exhibition at other institutions:-

National Museum, Copenhagen, Aarhus Museum and the Yorkshire Museum - specimens for inclusion in "The Vikings in England" exhibition

Fitzwilliam Museum - nine Indian sculptures for inclusion in the exhibition "India through British Eyes".

Part of a collection of British prehistoric material loaned to Birmingham Museums and Art Gallery in 1952 was returned to Cambridge.

CROWTHER-BEYNON FUND

The following grants were approved, for payment in August 1982, from the Fund established for the benefit of the Museum under the terms of the will of the late Mr V. B. Crowther-Beynon.

MAJOR GRANTS (existing collections)

Dr T. Holland, £1,000 for research on pottery from Dame Kathleen Kenyon's excavations at Jericho Museum of Archaeology and Anthropology, £3,000 for new archaeological displays in the Clarke Hall Mrs J. Roth, £1,000 for completion of editing for publication the Fiji journals of the Baron Anatole von Hügel, a former Curator.

MAJOR GRANTS (new collections)

Dr R. Abrahams, £750 for research into craft activity in Finland
Mr J. Darling, £1,500 for documentation of a collection of Balinese shadow puppets acquired by the Museum Mr A. Mawson, £800 for work on Dinka material culture, southern Sudan Museum of Archaeology and Anthropology, £1,000 to establish an Acquisition of Specimens Fund Miss A. Srinivasan, £1,000 for research on music in southern India Miss A. Welbourn and Miss H. Moore, £900 for continuing investigations of Marakwet culture in Kenya.

MINOR GRANTS

Professor J. Coles, £250 for excavations in the Somerset
Levels

Mr P. Lane, £240 for research on Dogon textiles, Mali Mr
D. Moore, £250 to aid publication of a catalogue of
artefacts from the Torres Straits

Dr J. Oates, £250 for excavations at Tel Brak, Syria

Dr C. Scarre, £200 for excavations at Bougon, Brittany.

TEACHING

All members of the curatorial staff contributed to the teaching programme of the Faculty of Archaeology and Anthropology through lectures, seminars and practical classes. Particular importance is attached to the fact that, for the first time this year, an M.Phil. course "Social Anthropology and the Work of a Museum" was offered by the Department of Social Anthropology. The course, organised and largely taught by Dr Swallow, attracted five students. Discussions are currently being held with a view to a similar museological M.Phil. course being offered by the Department of Archaeology in future years.

PUBLICATIONS

As noted above, Ruth Bean of Bedford published a new (1982) edition of A. C. Haddon and L. E. Start: Iban or Sea Dyak Fabrics and their Patterns, a descriptive catalogue of the Iban fabrics in the Museum of Archaeology and Ethnology, Cambridge, originally published by Cambridge University Press in 1936. The new edition, copies of which may be obtained through booksellers or direct from the Museum, contains a preface and extended bibliography by Dr D. A. Swallow.

In addition, the following works, authored or co-authored by members of the Museum staff, were published during the year:- D. W. Phillipson, "The Later Stone Age in sub-Saharan Africa", Cambridge History of Africa vol. I (ed. J. D. Clark), Cambridge University Press, 1982, pp. 410-77.

D. W. Phillipson, "Early food production in sub-Saharan

Africa", Cambridge History of Africa vol. I (ed. J. D. Clark), Cambridge University Press, 1982, pp. 770-829.

D. W. Phillipson, "L'expansion bantoue en Afrique orientale et meridionale: les temoignages de l'archeologie et de la linguistique", L'Expansion Bantoue (ed. L. Bouquiaux), Paris, S.E.L.A.F., 1981, pp. 649-84.

D. W. Phillipson, "A preliminary archaeological reconnaissance of the Southern Sudan 1977-8", Azania XVI (1981) pp. 1-6.

D. W. Phillipson and D. Gifford, "Kulchurdo rock-shelter and the Stone Age of Mount Marsabit", Azania XVI (1981) pp. 167-180.

D. W. Phillipson and L. Phillipson, "The development of mankind", Cambridge Encyclopaedia of Africa (eds. R. Oliver and M. Crowder), Cambridge University Press, 1981, pp. 57-74.

D. A. Swallow, "Ashes and powers: myth, rite and miracle in an Indian god-man's cult", Modern Asian Studies, XVI, 1 (1982) pp. 123-158.

UNIVERSITY MUSEUM OF ARCHAEOLOGY AND ANTHROPOLOGY

DOWNING STREET

CAMBRIDGE

CB2 3DZ

Telephone Cambridge (0223) 59714